

**Hassell**

# BAKERY HILL RENEWAL PRECINCT CONCEPT PACKAGE

# **DESIGN STATEMENT**

**Bridge Street Precinct will be reinstated as a meeting place.**

**It will draw on Ballarat's history as a place for discovery, a place where old meets new and stories are uncovered. A place to continually explore, to come back to.**

# PROJECT OBJECTIVES

THRIVING

=

**DESIGN FOR  
FLEXIBILITY**

CONNECTED

=

**OPEN THE  
PRECINCT**

DISTINCTIVE

=

**REFLECT  
LOCAL  
PEOPLE  
& PLACE**

# PRECINCT PLAN

# PRECINCT PLAN

OCTOBER 2021

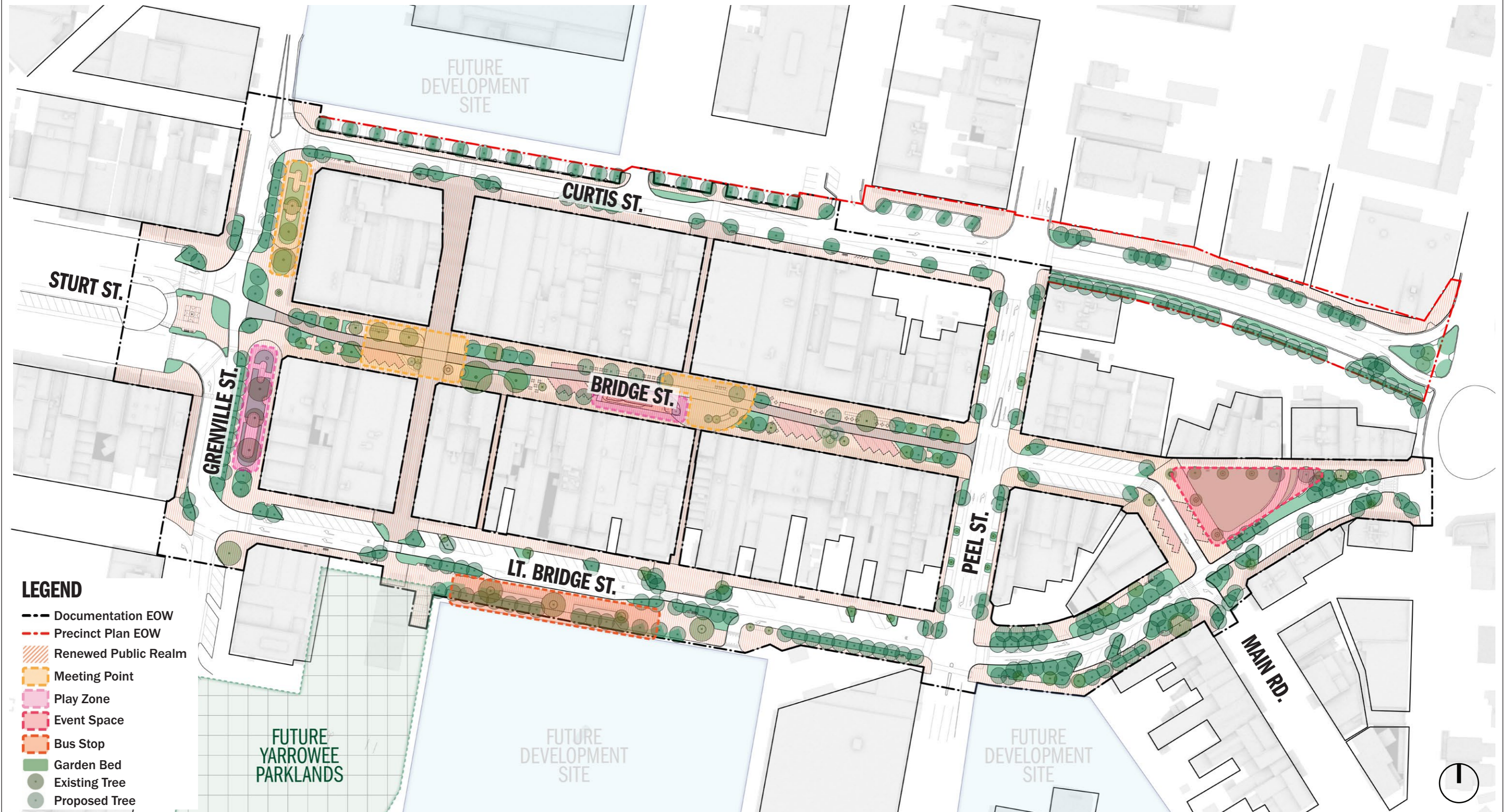

# ILLUSTRATIVE CONCEPT PLAN

OCTOBER 2021



# PRECINCT CYCLE NETWORK

CONNECTING INTO THE BALLARAT CYCLING ACTION PLAN

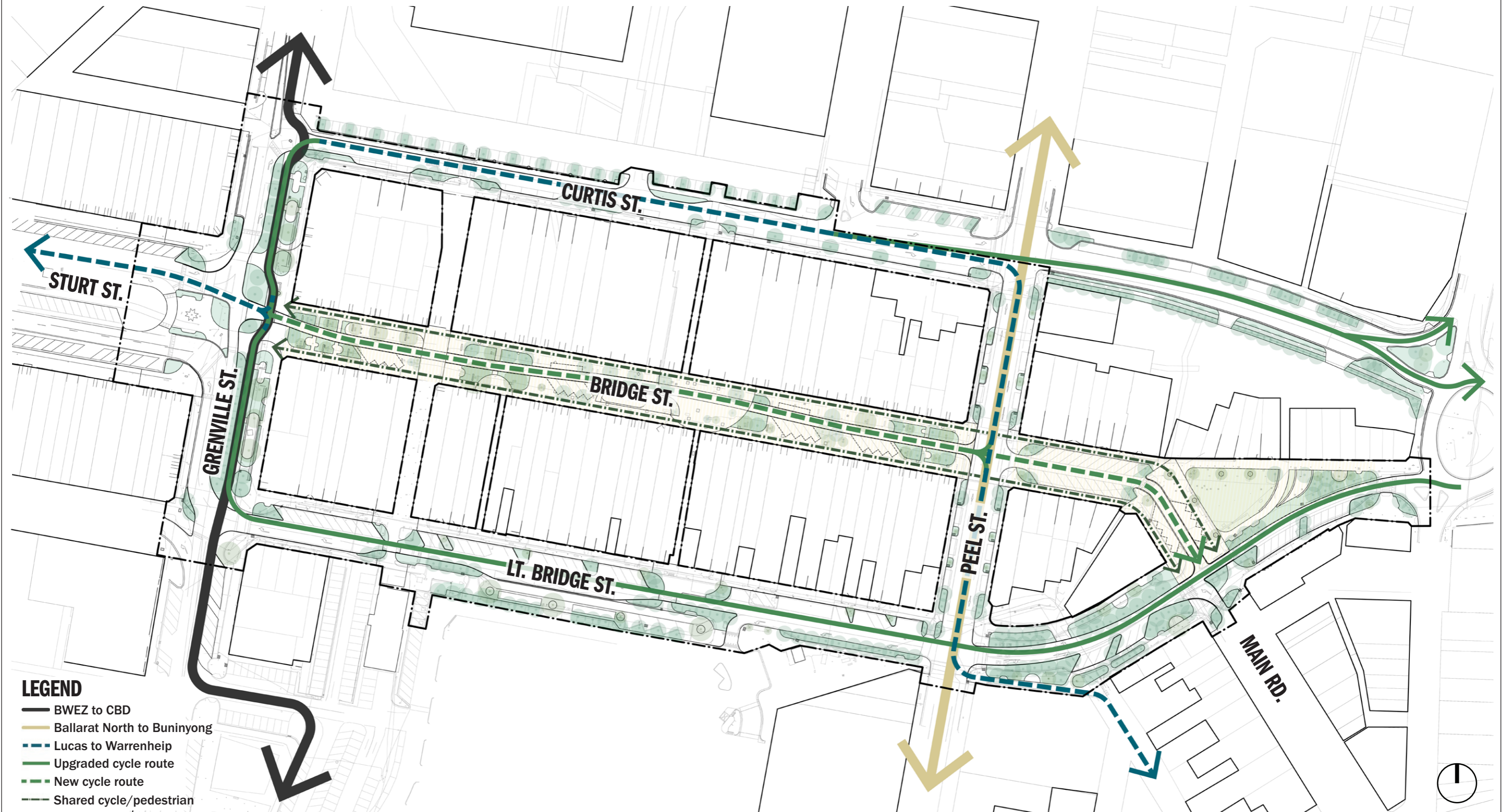

## LEGEND

- BWEZ to CBD
- Ballarat North to Buninyong
- - - Lucas to Warrenheip
- Upgraded cycle route
- - - New cycle route
- Shared cycle/pedestrian

# GRENVILLE STREET

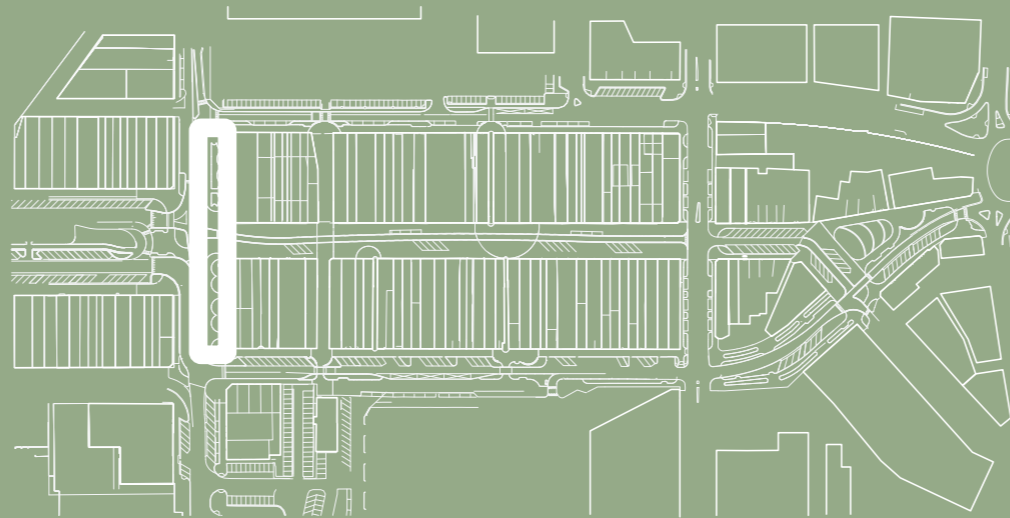



# GRENVILLE STREET

LINEAR PARK & GARDEN STREET



**a green street  
with legible structure**

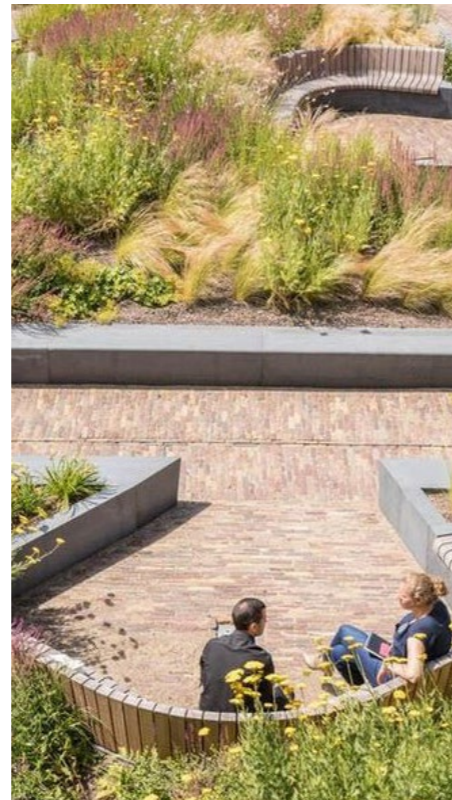

**quieter moments**



**immersed in planting**



**moments for play**



**gathering spaces  
+ future dining activation**

# GRENVILLE STREET

## REVISED STRUCTURE

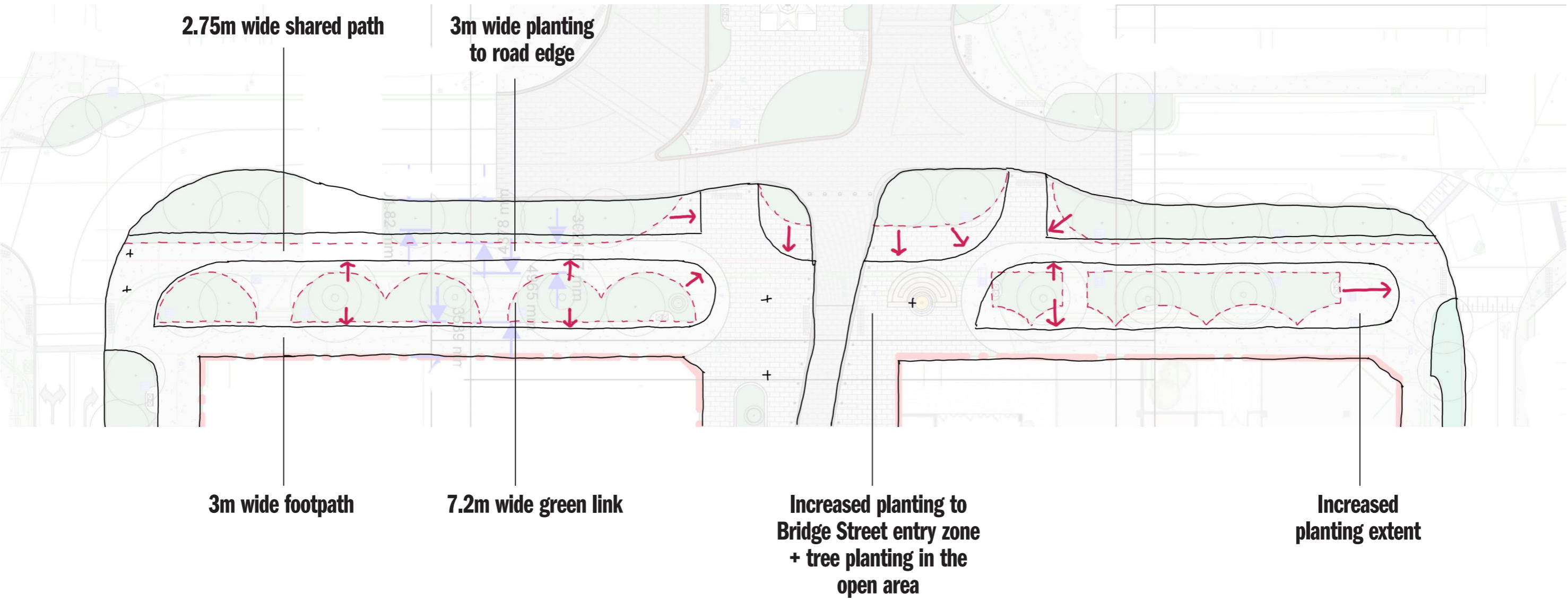

# GRENVILLE STREET

## SKETCH DEVELOPMENT

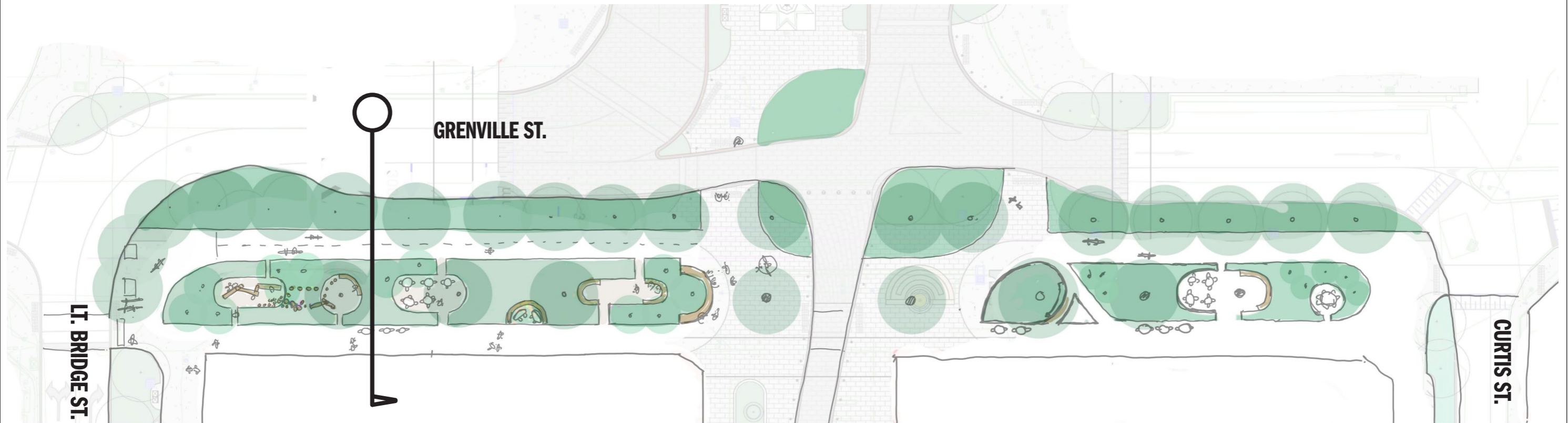

# GRENVILLE STREET

## CONCEPT DEVELOPMENT

- ① Extension of Sturt St gardens & public realm. Retention of existing monument.
- ② Consolidated pedestrian crossings for increased connectivity Central pedestrian
- ③ Grenville St shared path (SUP) that connects into BWEZ to CBD cycle route.
- ④ Quiet moments and gathering spaces for future dining and western tenancy activation
- ⑤ A green street with hidden moments for play immersed in planting
- ⑥ Green entry threshold and vegetated welcome into Bridge Street with tree planting and immersive planting to meet, sit and rest

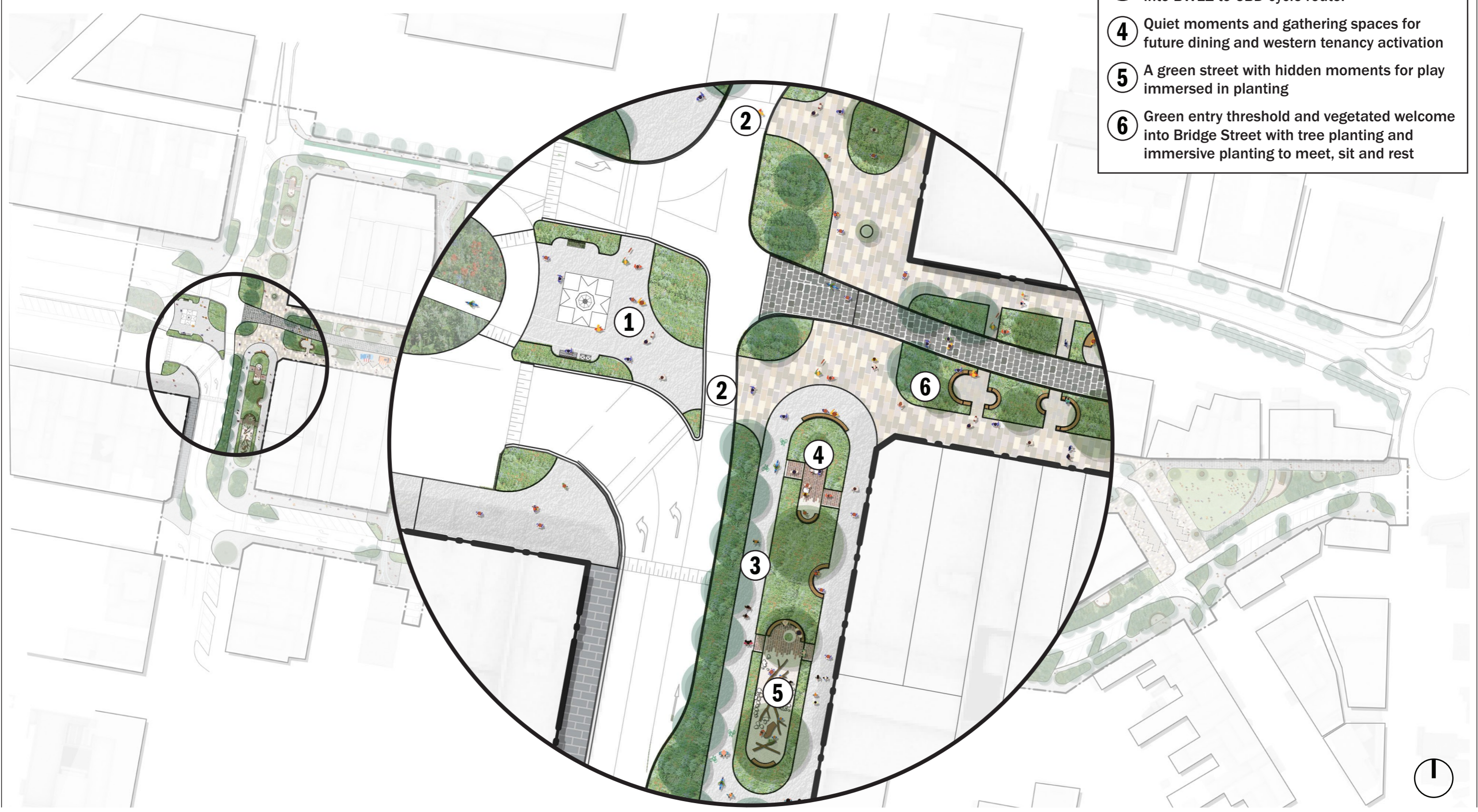

# GRENVILLE STREET

## REVISED CROSS SECTION

### KEY CONSIDERATIONS:

- Reduced pedestrian zone along western building edge to maximise opportunity for planting
- Shared path reduced to 2.75m as per Ausroads standards (Recommended recreational and regional commuter paths)
- Approximately 7m central garden street and linear park, with room for activity, gathering and respite
- Reduced western planting zone to provide separation from roadway

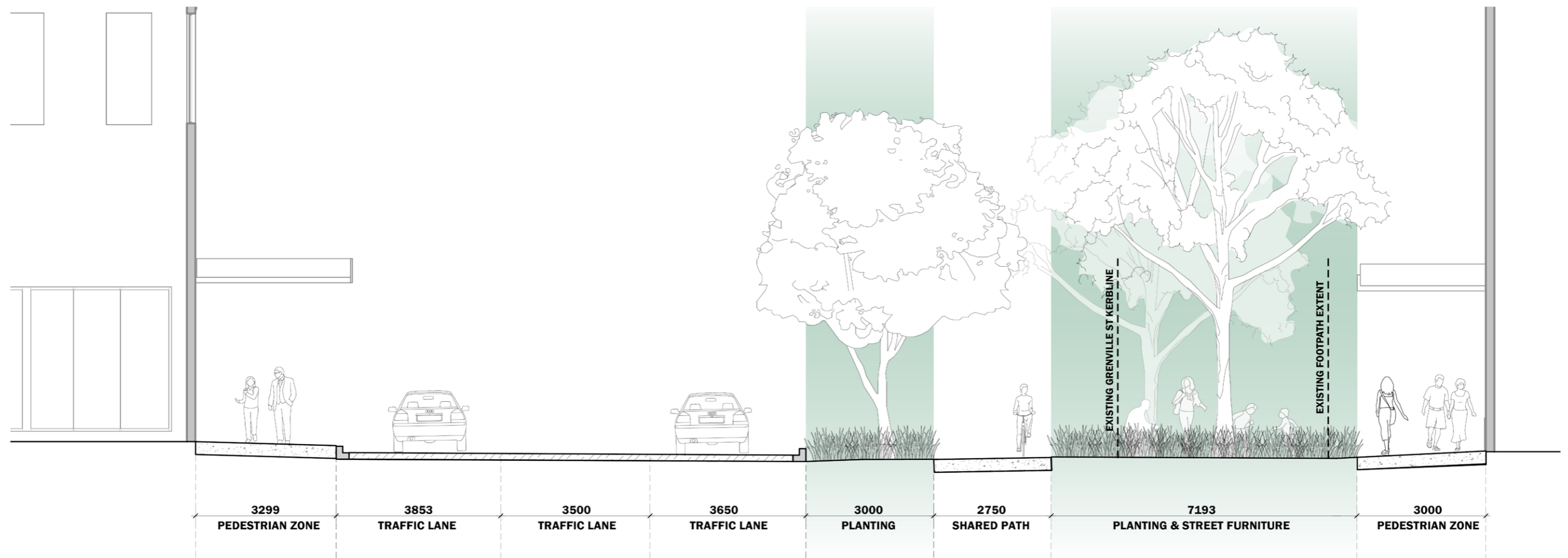

# GRENVILLE STREET

VIEW WEST TOWARDS BRIDGE & STURT STREET



# BRIDGE STREET

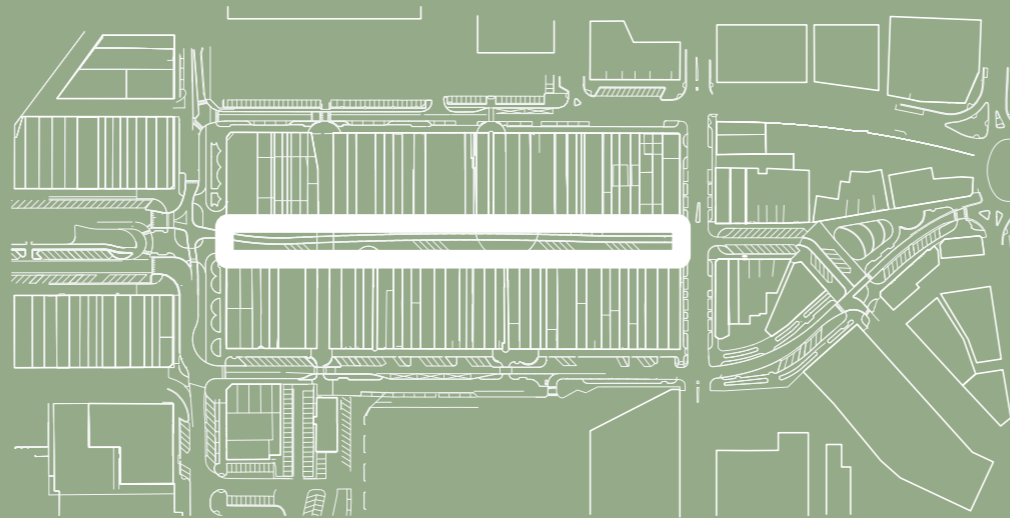

# BRIDGE STREET

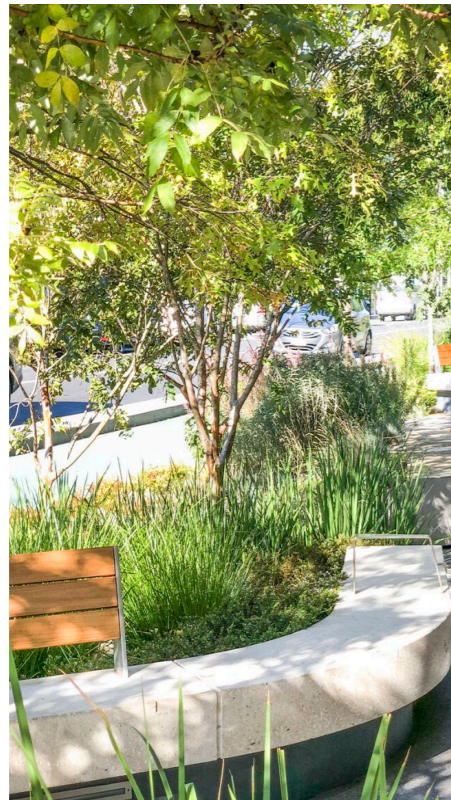

**green entry thresholds**

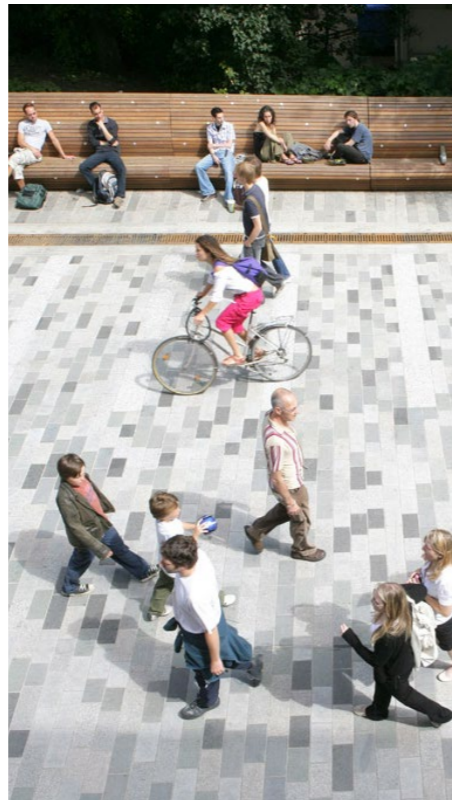

**a shared zone**



**providing a variety of functions**



**market, performance and event spaces**



**moments for play**



# BRIDGE STREET

## REVISED PRECINCT STRUCTURE

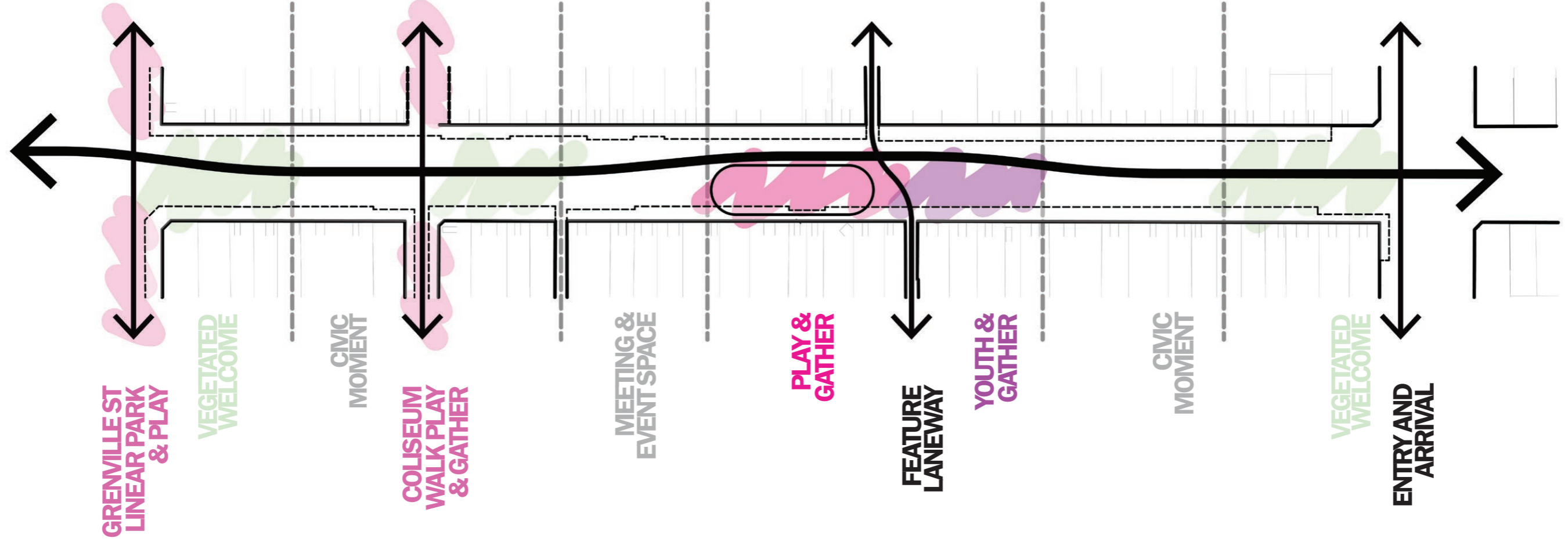

# BRIDGE STREET

## REVISED SKETCH DEVELOPMENT

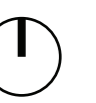
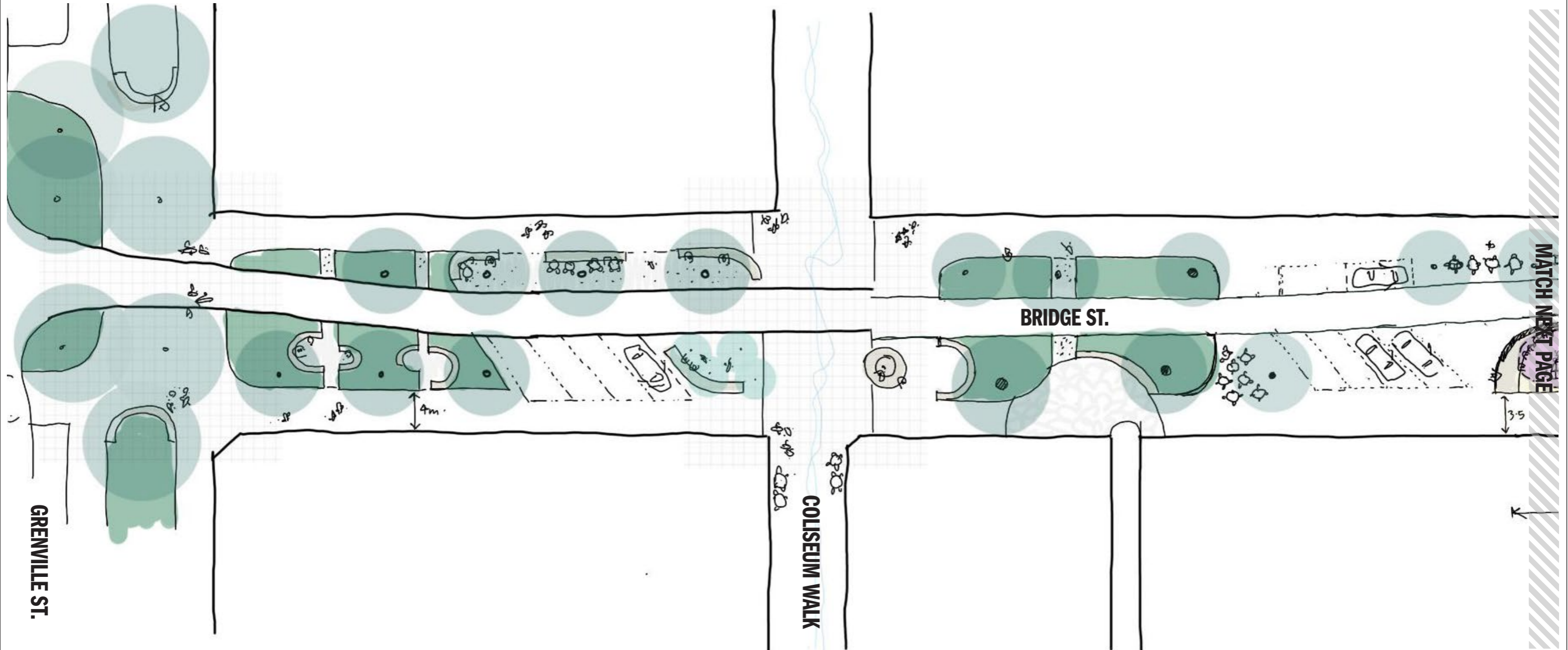
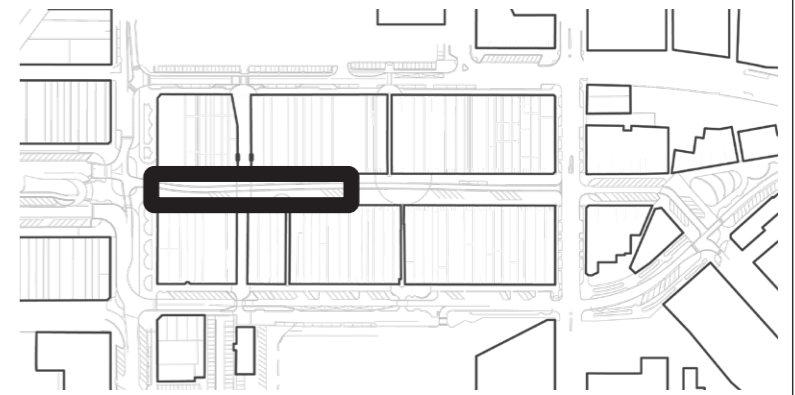

# BRIDGE STREET

## REVISED SKETCH DEVELOPMENT

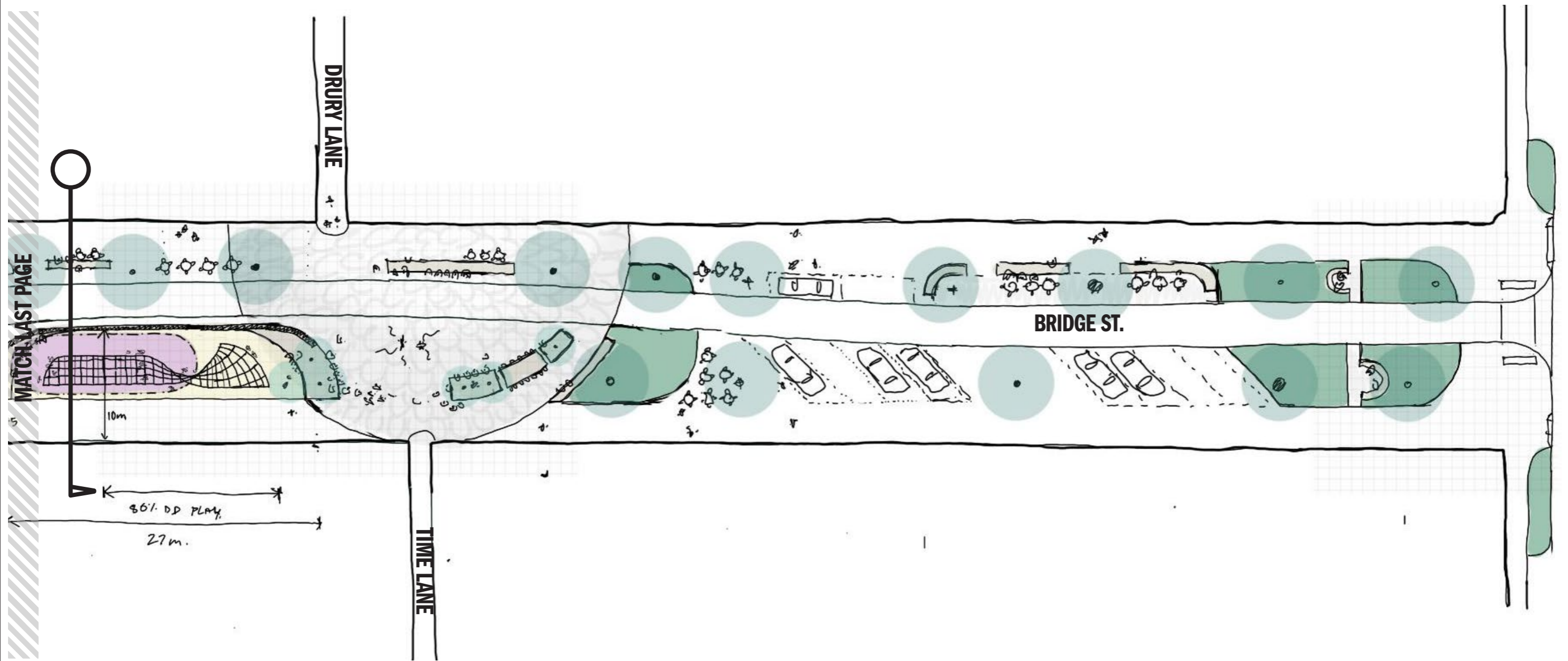
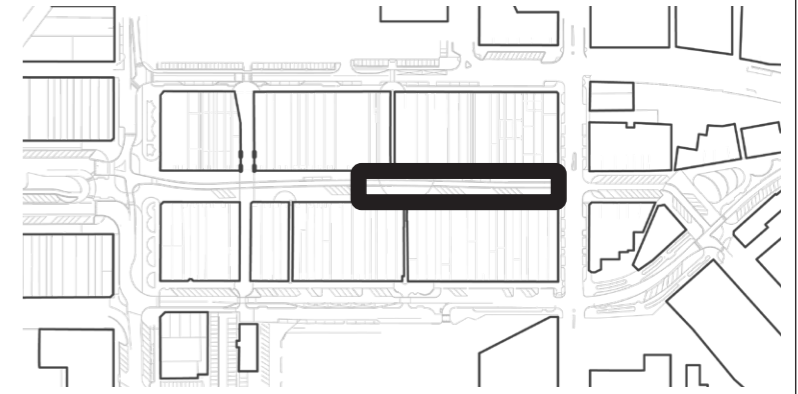

# BRIDGE STREET

## CONCEPT DEVELOPMENT

- ① Paving and material interpretation of the Yarrowee River through Coliseum Walk
- ② 'Porthole' to reveal the sight of the Yarrowee River below
- ③ Civic gathering and meeting space at Foundary Way
- ④ Loose furniture and dining opportunities for adjacent food, beverage and retail traders
- ⑤ Carparking and weekend event space
- ⑥ Central play space to be a combination of sculptural elements and water exploration including shelter, seating & vehicle protection
- ⑦ Central event and gathering space, paving treatment relating to Wadawurrung human gatherings and encampments
- ⑧ Shared 'long' dining table and eating space

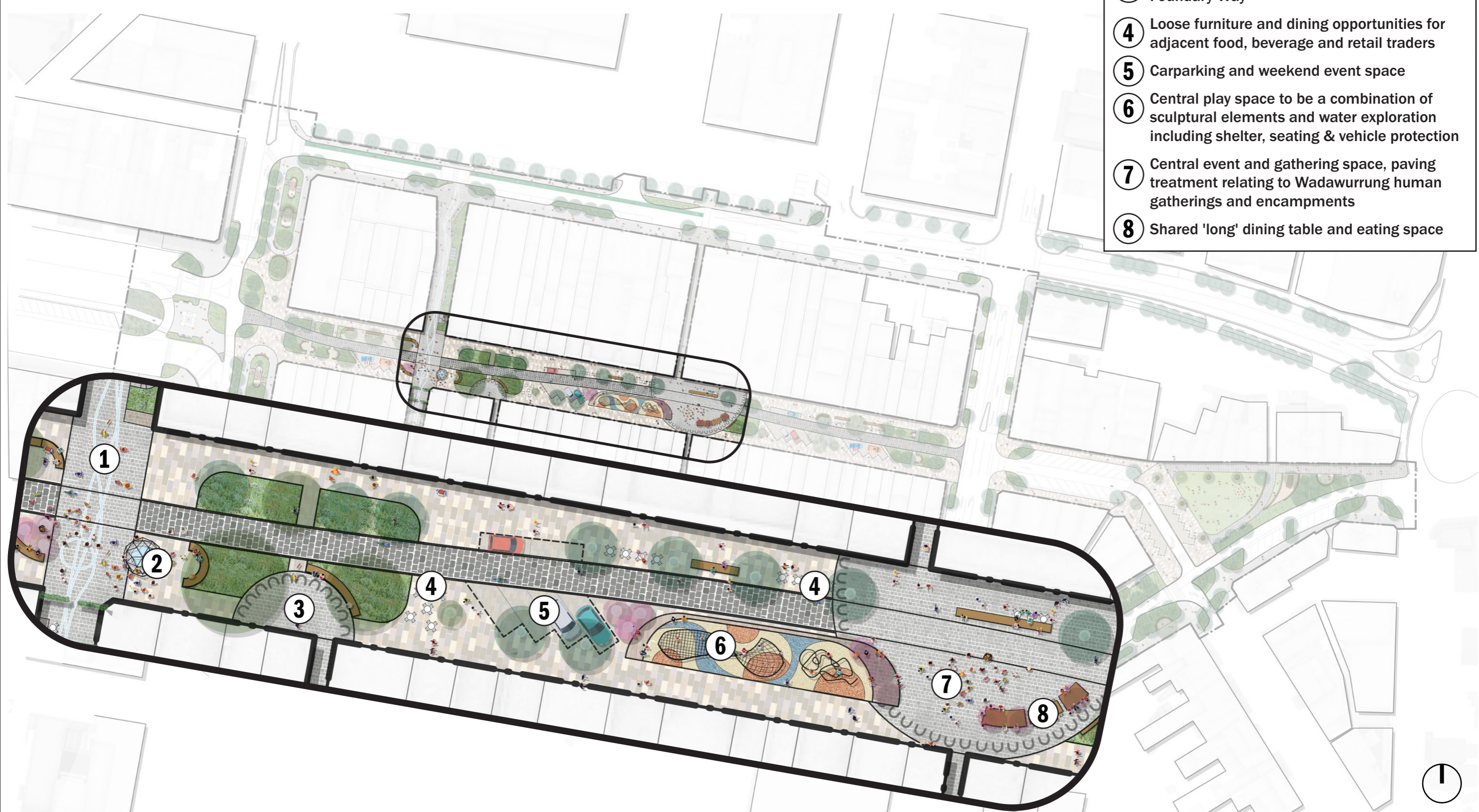

# GEOLOGY & INDUSTRY

## REFERENCING BALLAARAT'S LAYERS

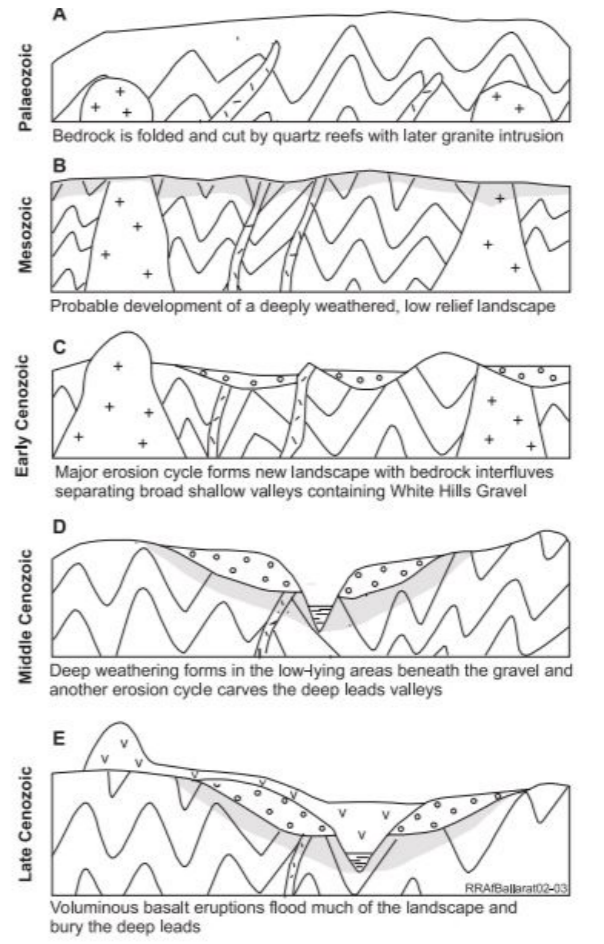
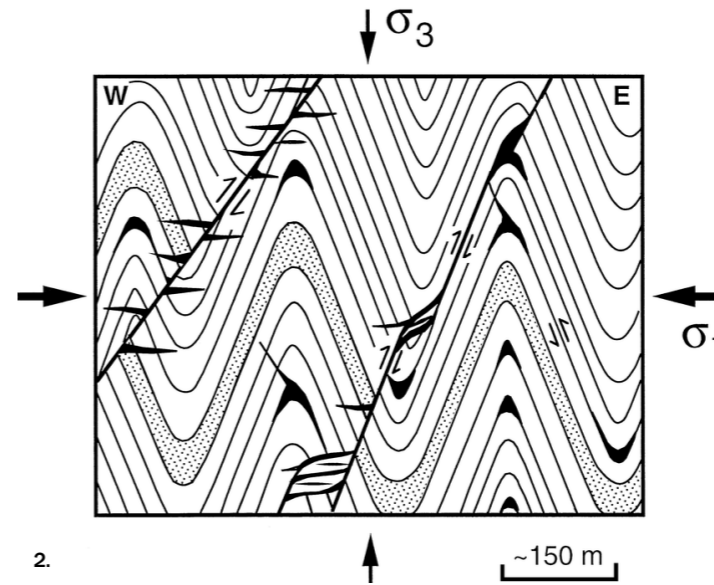
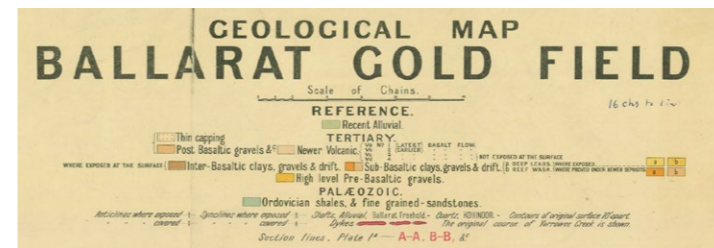
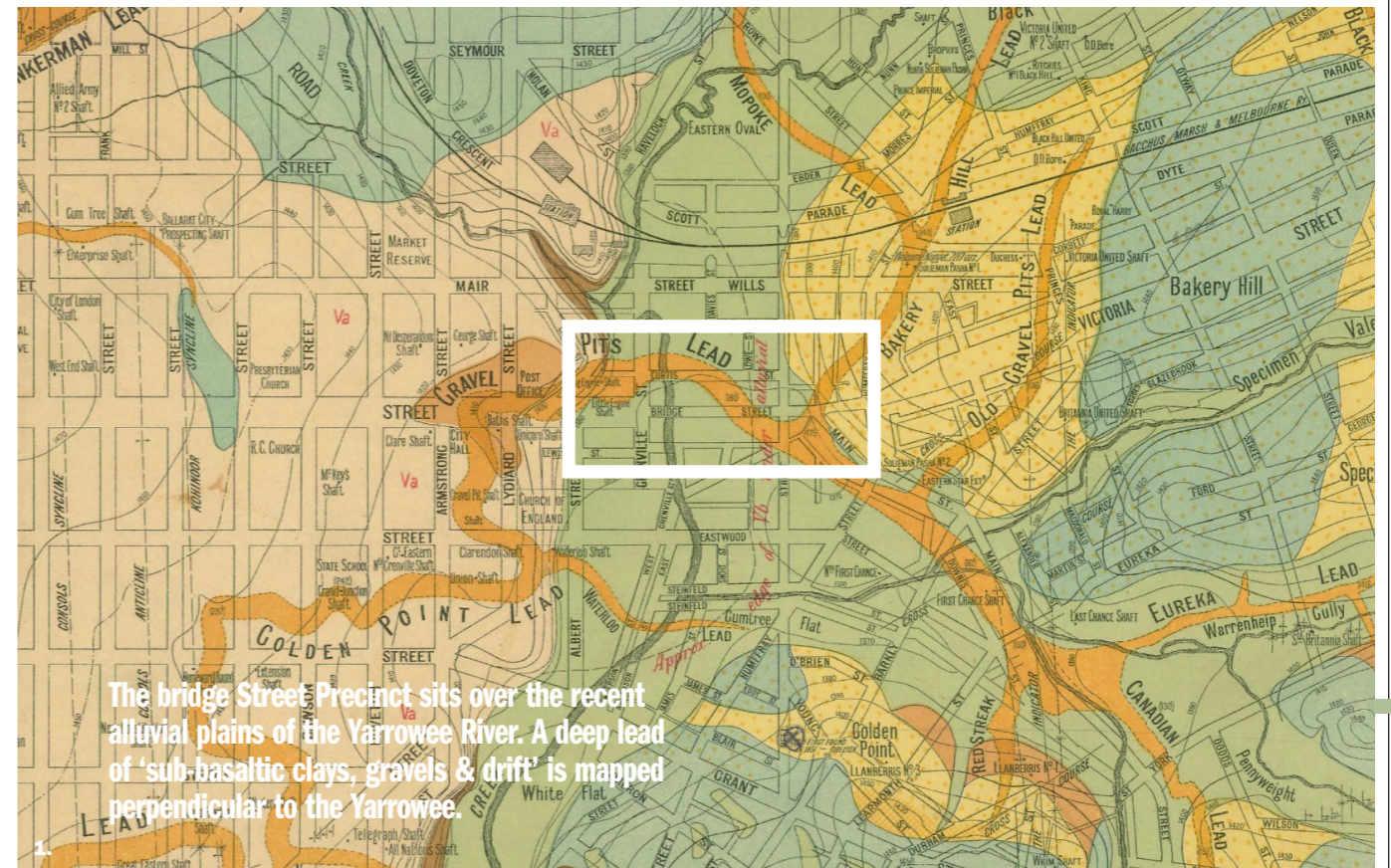

**Intent: Tell a nuanced story that references the Ballaarat's unique geology of sandstone and granite, it's quartz reefs and gold deposits.**

2. Images:  
1. Geological Map of Ballarat Gold Fields. Originally surveyed by W. Baragwanath for Geological Survey of Victoria 1917.  
2. Structural controls on gold-quartz mineralisation within the Bendigo-Ballaarat Zone of the Victorian goldfield. jogs after Cox et al., 1991b; Glen, 1995; Willman, 1995  
3. Ballarat landscape evolution through time, D.H. Taylor for Geological Survey of Victoria

# BRIDGE STREET

## MATERIAL EXPRESSION

**BLUESTONE LANES**  
Respect the historical laneways.  
Variation in scale, pattern &  
finish according to location.



**WARM STREETS**  
Reference the alluvial field of  
sandstone & granite gravel  
below.

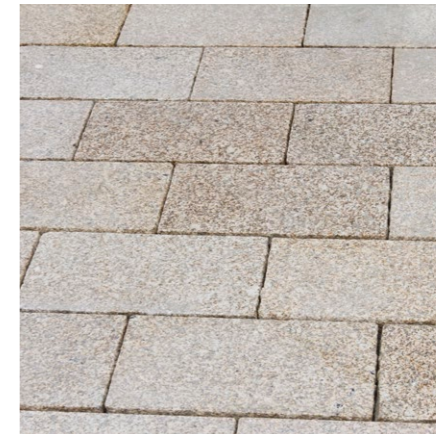

**DETAIL MOMENTS**  
High quality materials, like a  
quartz reefs of the Victorian  
gold fields.

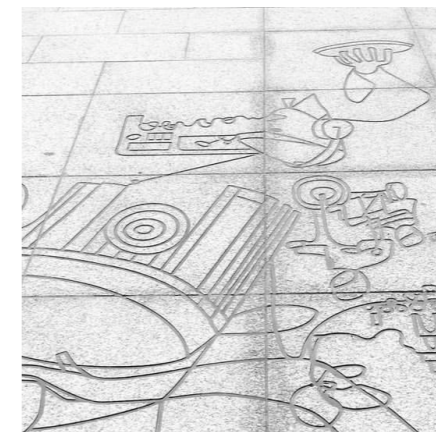

**Intent: Develop a cohesive and legible material palette spanning scale, application & function.**

**NUGGETS**  
Specs of gold through the  
wayfinding or art strategy  
complete the geological story.



# BRIDGE STREET

## STREET CANYON MATERIAL EXPRESSION

