

LINEMARKING DETAIL

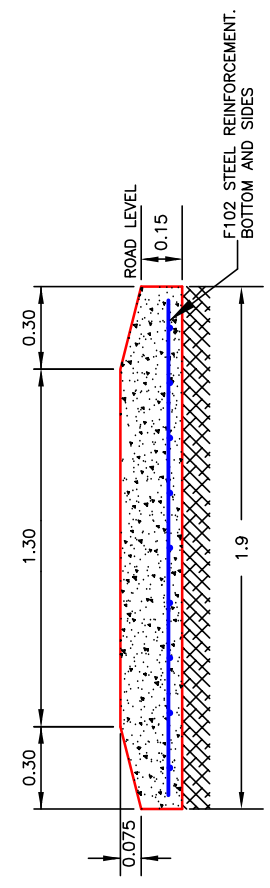

SECTION A-A

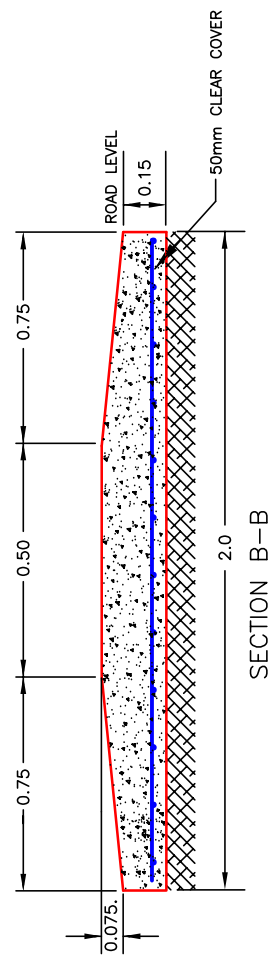

SECTION B-B

NOTES :

- ALL CONCRETE TO BE BLACK COLOURED WITH ROUGH SURFACE FINISH.
- PLACE RAMP ON 100mm MIN. COMPACTED CLASS 3 F.C.R.
- LINEMARKING PAINT TO BE DULUX'S WEATHERMAX (OR EQUIVALENT) HBR 2-PACK ACRYLIC TOPCOAT, APPLY A NON METALLIC ABRASIVE BETWEEN THE COATS OR ON THE FINISH COAT.
- ALL DIMENSIONS ARE IN METRES UNLESS OTHERWISE SHOWN.
- ALL SIGNAGE TO BE LOCATED IN ACCORDANCE WITH AS 1742.13.

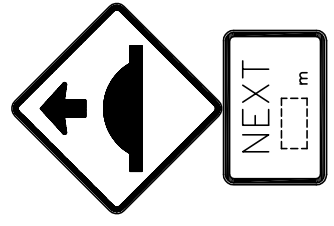

SPEED HUMPS AHEAD WARNING SIGN (W3-4)  
(SIGN W6-17 ONLY REQUIRED IF SPEED HUMPS ARE FIRST IN SERIES).

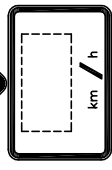
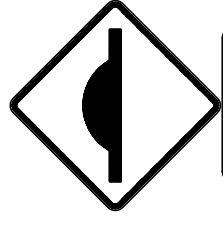

STANDARD SPEED HUMPS SIGN (W5-10)  
ADVISORY SPEED SIGN (W8-2)

SIGNAGE DETAIL

CITY OF BALLARAT

1 SIGNAGE ADDED 10 12 Approved by:-

No.	AMENDMENTS	DATE	Date:

CONCRETE PRE-CAST SPEED RAMP  
AND LINE MARKING DETAIL

SCALE:	NOT TO SCALE
SHEET 1	OF 1
DRAWING NO:	SD-T5

